

Illustrated Index

Rear Cover

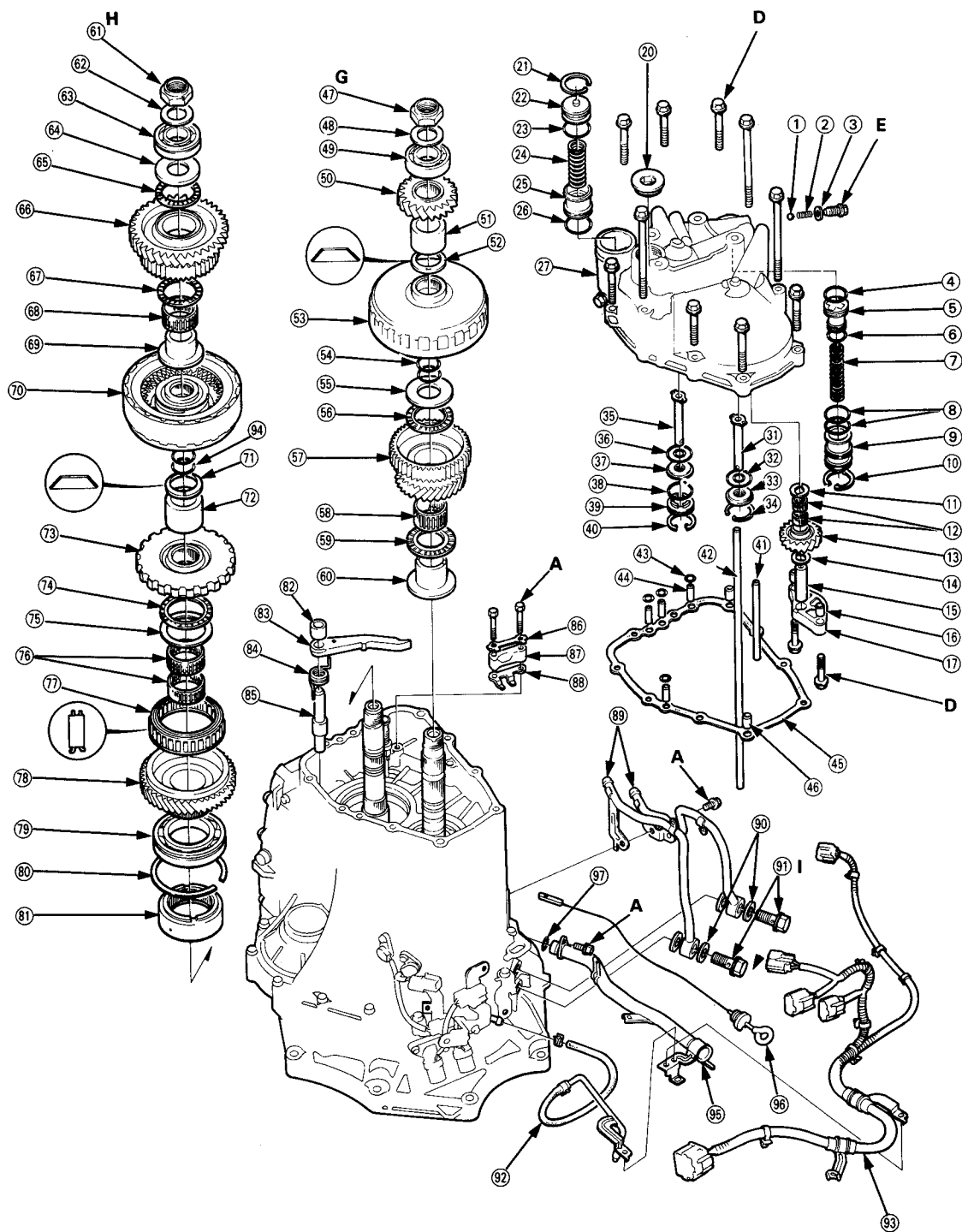



- ① STEEL BALL
- ② ONE-WAY BALL SPRING
- ③ SEALING WASHER Replace.
- ④ O-RING Replace.
- ⑤ REVERSE ACCUMULATOR PISTON
- ⑥ O-RINGS Replace.
- ⑦ REVERSE ACCUMULATOR SPRING
- ⑧ O-RINGS Replace.
- ⑨ REVERSE ACCUMULATOR SLEEVE
- ⑩ SNAP RING
- ⑪ THRUST WASHER. 14 x 30 mm
- ⑫ NEEDLE BEARINGS
- ⑬ REVERSE IDLER GEAR
- ⑭ THRUST WASHER, 14 x 25 mm
- ⑮ REVERSE IDLER GEAR SHAFT
- ⑯ DOWEL PIN
- ⑰ REVERSE IDLER GEAR SHAFT HOLDER
- ⑱ SEALING BOLT 34 x 1.25 mm
- ⑲ SNAP RING
- ⑳ 1ST-HOLD ACCUMULATOR SLEEVE
- ㉑ O-RING Replace.
- ㉒ 1ST-HOLD ACCUMULATOR SPRING
- ㉓ 1ST HOLD ACCUMULATOR PISTON
- ㉔ O-RING Replace.
- ㉕ REAR COVER
- ㉖ 2ND CLUTCH FEED PIPE
- ㉗ O-RING Replace.
- ㉘ FEED PIPE GUIDE
- ㉙ SNAP RING
- ㉚ REVERSE CLUTCH FEED PIPE
- ㉛ O-RING Replace.
- ㉜ FEED PIPE GUIDE
- ㉝ O-RING Replace.
- ㉞ OIL FEED GUIDE
- ㉟ SNAP RING
- ㊱ FEED PIPE
- ㊲ FEED PIPE
- ㊳ O-RING Replace.
- ㊴ OIL PIPE
- ㊵ REAR COVER GASKET Replace.
- ㊶ DOWEL PIN
- ㊷ MAINSHAFT LOCKNUT, 24 x 1.25 mm
Replace.
- ㊸ WASHER, 24 mm
Replace.

- ㊹ BALL BEARING
- ㊺ MAINSHAFT REVERSE GEAR
- ㊻ MAINSHAFT REVERSE GEAR DISTANCE COLLAR
- ㊼ MAINSHAFT DISC SPRING, 28 mm
Replace.
- ㊽ 2ND CLUTCH ASSEMBLY
- ㊾ O-RING Replace.
- ㊿ THRUST WASHER. 29 mm
- ① THRUST NEEDLE BEARING
- ② MAINSHAFT 2ND GEAR
- ③ NEEDLE BEARING
- ④ THRUST NEEDLE BEARING
- ⑤ MAINSHAFT 2ND GEAR COLLAR
- ⑥ COUNTERSHAFT LOCKNUT, 24 x 1.25 mm
Replace.
- ⑦ WASHER, 24 mm Replace.
- ⑧ BALL BEARING
- ⑨ THRUST WASHER, 25 mm
- ⑩ THRUST NEEDLE BEARING
- ⑪ COUNTERSHAFT REVERSE GEAR
- ⑫ THRUST NEEDLE BEARING
- ⑬ NEEDLE BEARING
- ⑭ COUNTERSHAFT REVERSE GEAR COLLAR
- ⑮ REVERSE CLUTCH ASSEMBLY
- ⑯ COUNTERSHAFT DISC SPRING, 29 mm
Replace.
- ⑰ REVERSE CLUTCH DISTANCE COLLAR
- ⑱ PARKING GEAR
- ⑲ THRUST NEEDLE BEARING
- ㉑ THRUST WASHER, 45.5 x 60 mm Selective part
- ㉒ NEEDLE BEARINGS
- ㉓ 2ND GEAR ONE-WAY CLUTCH
- ㉔ COUNTERSHAFT 2ND GEAR
- ㉕ BALL BEARING
- ㉖ SNAP RING
- ㉗ ONE-WAY CLUTCH HUB
- ㉘ PARKING BRAKE PAWL SHAFT SLEEVE
- ㉙ PARKING BRAKE PAWL
- ㉚ PARKING BRAKE PAWL SPRING
- ㉛ PARKING BRAKE PAWL SHAFT
- ㉜ LOCK PLATE Replace.
- ㉝ PARKING BRAKE ROD HOLDER
- ㉞ PARKING BRAKE ROD GUIDE
- ㉟ ATF COOLER PIPES
- ㊱ SEALING WASHER Replace.
- ㊲ JOINT BOLT
- ㊳ BREATHER PIPE
- ㊴ TRANSMISSION SUB-HARNESS
- ㊵ O-RING Replace.
- ㊶ ATF LEVEL GAUGE PIPE
- ㊷ ATF LEVEL GAUGE (DIPSTICK)
- ㊸ O-RING Replace.

TORQUE SPECIFICATIONS

No.	Torque Value	Bolt Size	Remarks
A	12 N·m (1.2 kg-m, 9 lb-ft)	6 x 1.0 mm	
D	27 N·m (2.7 kg-m, 20 lb-ft)	8 x 1.25 mm	
E	18 N·m (1.8 kg-m, 13 lb-ft)	8 x 1.25 mm	Sealing Bolt
G	130 N·m (13.0 kg-m, 94 lb-ft)	24 x 1.25 mm	Mainshaft Locknut
H	130 N·m (13.0 kg-m, 94 lb-ft)	24 x 1.25 mm	Countershaft Locknut (Left-hand threads)
I	40 N·m (4.0 kg-m, 29 lb-ft)	14 x 1.5 mm	Joint Bolt